

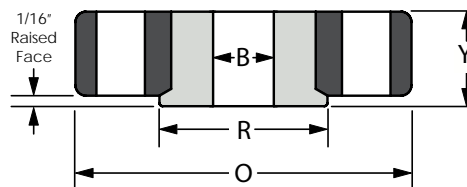

CLASS 150#
 Standard Flange Thickness
 Reducing Slip-On Conventional (RC)
SERIES# RC-150 (CONVENTIONAL)

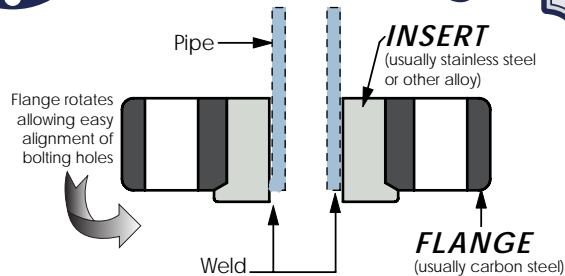

RC-150 SERIES • REDUCING SLIP-ON

Part Number *see note 1.	Flange Size	Nominal Pipe Size	O (Outside Diameter)	R (Raised Face)	B (Inside Diameter)	Y (Overall Length)	# of Holes - Diameter	Bolt Circle Dia.	Estimated Weight (in lbs.)
RC-150/.75X.5	3/4"	1/2"	3.88	1.69	0.88	0.50	4 - 0.63	2.75	2.5
RC-150/1X.5	1"	1/2"	4.25	2.00	0.88	0.56	4 - 0.63	3.13	3.0
RC-150/1X.75		3/4"	4.25	2.00	1.09	0.56	4 - 0.63	3.13	3.0
RC-150/1.5X.5	1-1/2"	1/2"	5.00	3.00	0.88	0.69	4 - 0.63	3.88	3.5
RC-150/1.5X.75		3/4"	5.00	3.00	1.09	0.69	4 - 0.63	3.88	3.5
RC-150/1.5X1		1"	5.00	3.00	1.36	0.69	4 - 0.63	3.88	3.5
RC-150/2X.5	2"	1/2"	6.00	3.63	0.88	0.75	4 - 0.75	4.75	4.5
RC-150/2X.75		3/4"	6.00	3.63	1.09	0.75	4 - 0.75	4.75	4.5
RC-150/2X1		1"	6.00	3.63	1.36	0.75	4 - 0.75	4.75	4.5
RC-150/2X1.5		1-1/2"	6.00	3.63	1.95	0.75	4 - 0.75	4.75	4.5
RC-150/2.5X.5	2-1/2"	1/2"	7.00	4.25	0.88	0.88	4 - 0.75	5.50	5.0
RC-150/2.5X.75		3/4"	7.00	4.25	1.09	0.88	4 - 0.75	5.50	5.0
RC-150/2.5X1		1"	7.00	4.25	1.36	0.88	4 - 0.75	5.50	5.0
RC-150/2.5X1.5		1-1/2"	7.00	4.25	1.95	0.88	4 - 0.75	5.50	5.0
RC-150/2.5X2		2"	7.00	4.25	2.44	0.88	4 - 0.75	5.50	5.0
RC-150/3X.5	3"	1/2"	7.50	5.00	0.88	0.94	4 - 0.75	6.00	5.5
RC-150/3X.75		3/4"	7.50	5.00	1.09	0.94	4 - 0.75	6.00	5.5
RC-150/3X1		1"	7.50	5.00	1.36	0.94	4 - 0.75	6.00	5.5
RC-150/3X1.5		1-1/2"	7.50	5.00	1.95	0.94	4 - 0.75	6.00	5.5
RC-150/3X2		2"	7.50	5.00	2.44	0.94	4 - 0.75	6.00	5.5
RC-150/3X2.5		2-1/2"	7.50	5.00	2.94	0.94	4 - 0.75	6.00	5.5
RC-150/4X.5	4"	1/2"	9.00	6.19	0.88	0.94	8 - 0.75	7.50	7.0
RC-150/4X.75		3/4"	9.00	6.19	1.09	0.94	8 - 0.75	7.50	7.0
RC-150/4X1		1"	9.00	6.19	1.36	0.94	8 - 0.75	7.50	7.0
RC-150/4X1.5		1-1/2"	9.00	6.19	1.95	0.94	8 - 0.75	7.50	7.0
RC-150/4X2		2"	9.00	6.19	2.44	0.94	8 - 0.75	7.50	7.0
RC-150/4X2.5		2-1/2"	9.00	6.19	2.94	0.94	8 - 0.75	7.50	7.0
RC-150/4X3		3"	9.00	6.19	3.57	0.94	8 - 0.75	7.50	7.0
RC-150/6X2	6"	2"	11.00	8.50	2.44	1.00	8 - 0.88	9.50	9.0
RC-150/6X3		3"	11.00	8.50	3.57	1.00	8 - 0.88	9.50	9.0
RC-150/6X4		4"	11.00	8.50	4.57	1.00	8 - 0.88	9.50	9.0
RC-150/8X4	8"	4"	13.50	10.63	4.57	1.13	8 - 0.88	11.75	11.0
RC-150/8X6		6"	13.50	10.63	6.72	1.13	8 - 0.88	11.75	11.0
RC-150/10X6	10"	6"	16.00	12.75	6.72	1.19	12 - 1.00	14.25	13.5
RC-150/10X8		8"	16.00	12.75	8.72	1.19	12 - 1.00	14.25	13.5
RC-150/12X8	12"	8"	19.00	15.00	8.72	1.25	12 - 1.00	17.00	16.0
RC-150/12X10		10"	19.00	15.00	10.88	1.25	12 - 1.00	17.00	16.0

1. Complete part number would have a / then material of the insert (ex. RC-150/2x1/316L this is a 2"x1" reducing insert flange with a 316L insert and

carbon steel flange. * For other notes see the S-150 Series. All of these notes at the footer apply to this series but were omitted for space reasons.